

# Bullet Cable

CUSTOMIZE CABLES AND PATCH CORDS FOR YOUR RIG IN JUST FOUR EASY STEPS!

## STEP 1

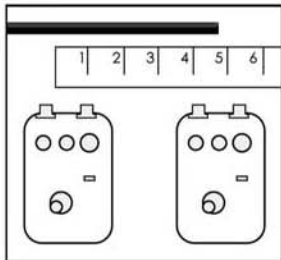

MEASURE AND MARK YOUR DESIRED CABLE LENGTH.

(WHEN DECIDING ON A LENGTH, CONSIDER THE SET-UP OF YOUR GEAR AND HOW YOU MOVE WHEN YOU PLAY.)

BE SAFE: RAZORS ARE SHARP. ALWAYS CUT AWAY FROM YOUR BODY!

## STEP 2

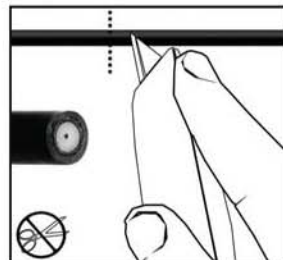

PLACE THE CABLE ON A FLAT CUTTING SURFACE. USING A RAZOR BLADE, CAREFULLY MAKE A STRAIGHT, CLEAN CUT THROUGH THE CABLE.

(CABLES WITH MOON-SHAPED OR DIAGONAL CUTS MAY NOT WORK PROPERLY.)

DO NOT USE SCISSORS OR WIRE CUTTERS. THEY DO NOT MAKE STRAIGHT CUTS.

## STEP 3

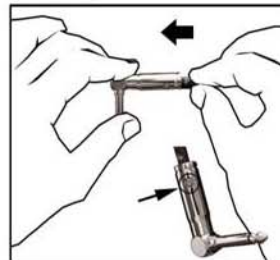

REMOVE THE SCREW AT THE CONNECTOR BASE BY TURNING IT COUNTERCLOCKWISE WITH THE HEX KEY (INCLUDED WITH BULLET CABLE DIY CONNECTORS). GENTLY INSERT THE CABLE INTO THE CONNECTOR OPENING UNTIL IT TOUCHES THE SPIKE INSIDE.

DO NOT PUSH THE CABLE TOO HARD. FORCING IT PAST THE SPIKE MAY DAMAGE THE CABLE.

## STEP 4

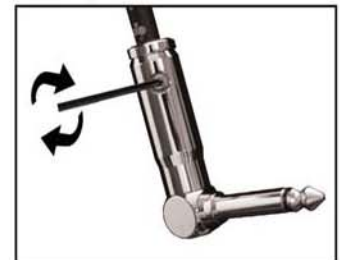

RETURN THE SCREW TO ITS ORIGINAL POSITION BY TURNING IT CLOCKWISE WITH THE HEX KEY UNTIL IT'S SNUG. DO NOT OVER-TIGHTEN.

THAT'S IT! YOU'RE DONE!

HAVE QUESTIONS? VISIT OUR SITE:

 [COREONEPRODUCT.COM](http://COREONEPRODUCT.COM)